

## The bottom-up approach.

Social networking tools, collaboration, and people-centric environments; the bases for relevant learning and teaching.

Research shows that in spite of the availability of in class training and eLearning courses, employees and students gain most new knowledge informally using Google-like search and through collaboration with colleagues.

Today's learning systems focus on web based courses and classroom training. They take a top-down, command and control approach for delivering, tracking and creating new training materials. Additionally, typical enterprise learning environments, the LMS(Learning Management System) and learning content creation tools are often both unpopular and difficult to use by the learners themselves and managers.

Taking a bottom-up approach to training content production in an organization leads to another problem; information overload and lack of relevance. Today's learners typically have access to an endless stream of peer generated content, HTML, PDFs, video, audio, PowerPoints as well as traditional eLearning and classroom training. All too often, both management and the users themselves find it hard to tell which of these has real value for both job performance and career growth.

## Built-in, collective intelligence.

Automatic tagging based on popularity, expertise of author, job title, role, department...Infuse knows and delivers.

Infuse has a built-in collective intelligence engine that combines and sorts multiple metrics about a user and content to make sure the right content goes to the right person. Not only tracking tags but expertise of the author, popularity of content amongst those in the same group or job and time spent viewing the content to name a few. This helps to align a learner's existing learning path and competencies. Applying learning standards such as SCORM, Infuse tracks all viewed content such as classroom training and most every wiki, forum or online and expert collaboration.

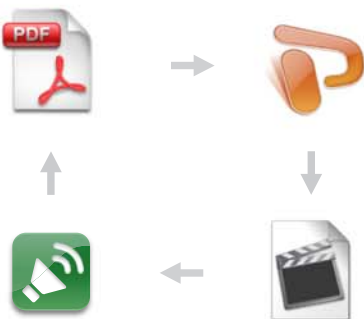

## Learning and teaching without limits.

Combining PDF, MS PowerPoint, video and audio, blogs, discussions and wikis has never been simpler.

Built on the latest Web 2.0 standards, Infuse is both easy to use, deploy and, most importantly, manage by everyone. Infuse is one of the first learning/authoring systems designed for everyone to completely train employees and peers while delivering only the most meaningful content and job know-how. In addition to standard elearning content, Infuse easily combines PDFs, MS Powerpoints, video and audio content as well as third party applications like Skillsoft, turning them into eLearning standard/SCORM based training content complete with assessments and surveys.